

# The ARTristic Easel

"The artists that buy an ARTristic easel are different. They are innovative creators. They don't use this easel because it can make painting pain free and easier. They use it because they believe that change and risk will more often than not lead to better and more exciting art. Some see them as "breakers of tradition". We see them as visionary pioneers. "Groundbreakers" of the art world that wish to make a difference. We are privileged to help them do this. They are the people we designed this easel for.

## OPERATING MANUAL

Sept 2015

© North Paw Design Co Pty Ltd

DESIGNED BY AN  
ARTIST TO IMPROVE  
YOUR PHYSICAL WELL  
BEING AND YOUR ART.

### \*PLEASE NOTE:

Some minor easel fittings  
may differ slightly on the  
USA and the Australian  
made Mark 4 Easel

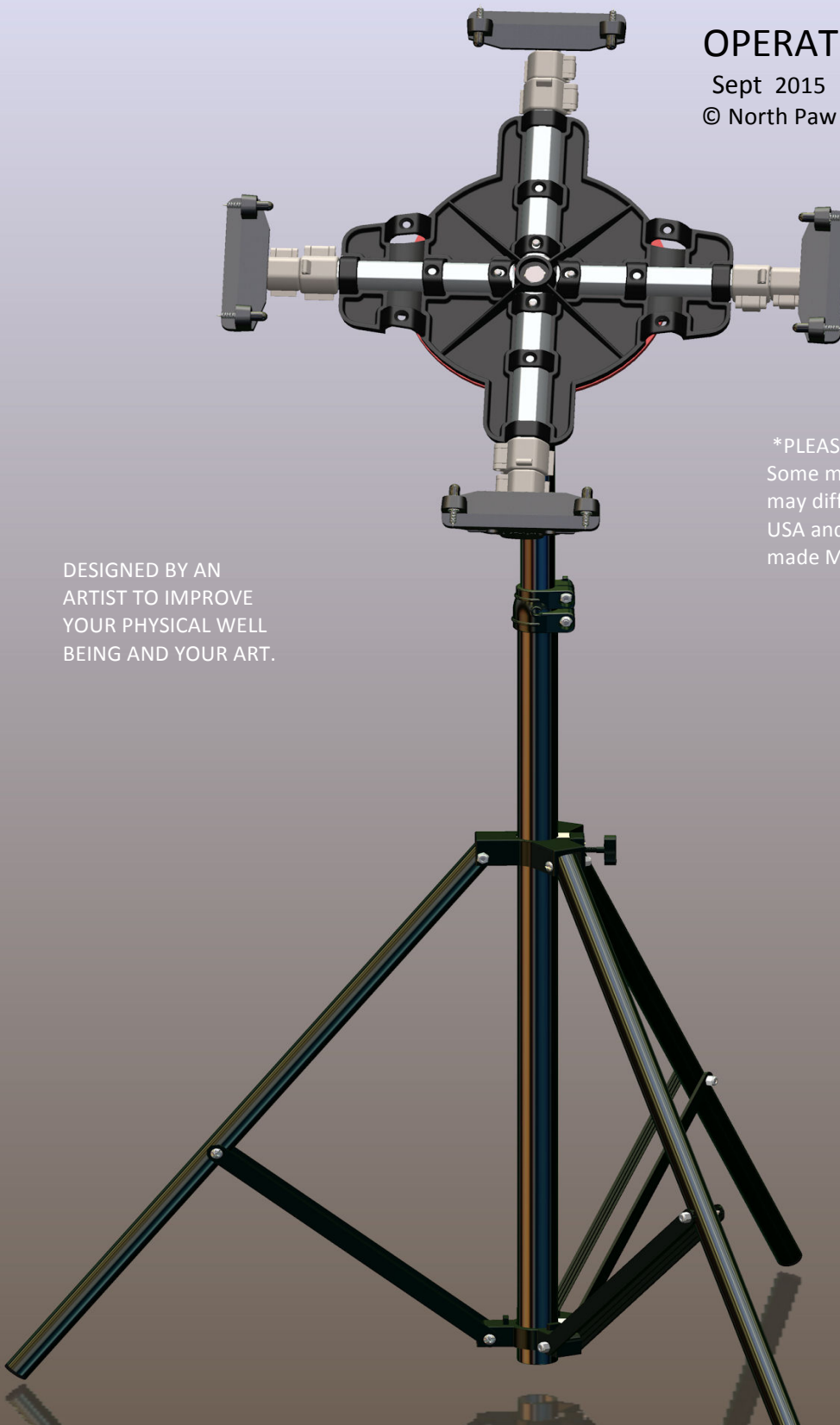

Congratulations. You are now the owner of the worlds most artist friendly easel.

## “TRADITION”

Traditions are an integral part of society. This includes the world of art. But it is essential that traditions be receptive to adjustments, improvements and new ideas that will enhance, enlighten and benefit the lives of those they serve. These progressive steps often establish new traditions and they are of no less importance than those of the past.

As you paint, a working and creative partnership will develop between you and this easel.

It has been designed to work with you, increase your creative freedom and allow you to discover your full creative potential as an artist. This groundbreaking easel is the result of the collaboration, input and requests from hundreds of artist around the world just like you and I. We've all had problems when painting with our traditional easels. Problems and barriers that until now have never been fully listened to, analyzed or addressed. When these problems are removed, unexpected changes will effect the way that you paint forever.

When you use an ARTristic Easel you will become a trailblazer. A true visionary artist and a key part of establishing a new tradition in art. And for that I thank you.

Tony Barber: Artist/Author/ Teacher/Designer of the ARTristic Easel



### You can attach to the easel ....

Canvas stretchers  
Drawing boards (up to approx. 70cm x 70cm maximum)  
Canvas boards  
White boards with wooden frames  
Black boards with wooden frames

Sitting for long periods of time while using a computer is not healthy. Use double sided tape to fix a place mat to the top of the black steel disc of the easel to create an adjustable table on which to place your mouse and or keyboard.

Paint while standing  
Painting while sitting (including in wheel chairs)  
Oil and acrylic artists  
Water color artists,  
Pastel artists  
Scraperboard artists  
Air brush artists  
Illustrators  
Craft projects  
Speed Painters  
Adjustable speakers lectern  
Adjustable table for standing while using a computer  
Public speakers and presenters (rotating white board)  
Art galleries (to create floor to ceiling multi level displays of artworks in areas of limited or previously unusable space)



\*Please follow the instructions page by page, in the order they are in this document. Especially if you are a male artist!

# The ARTristic Easel

© North Paw Design Co Pty Ltd 2014

Page 2

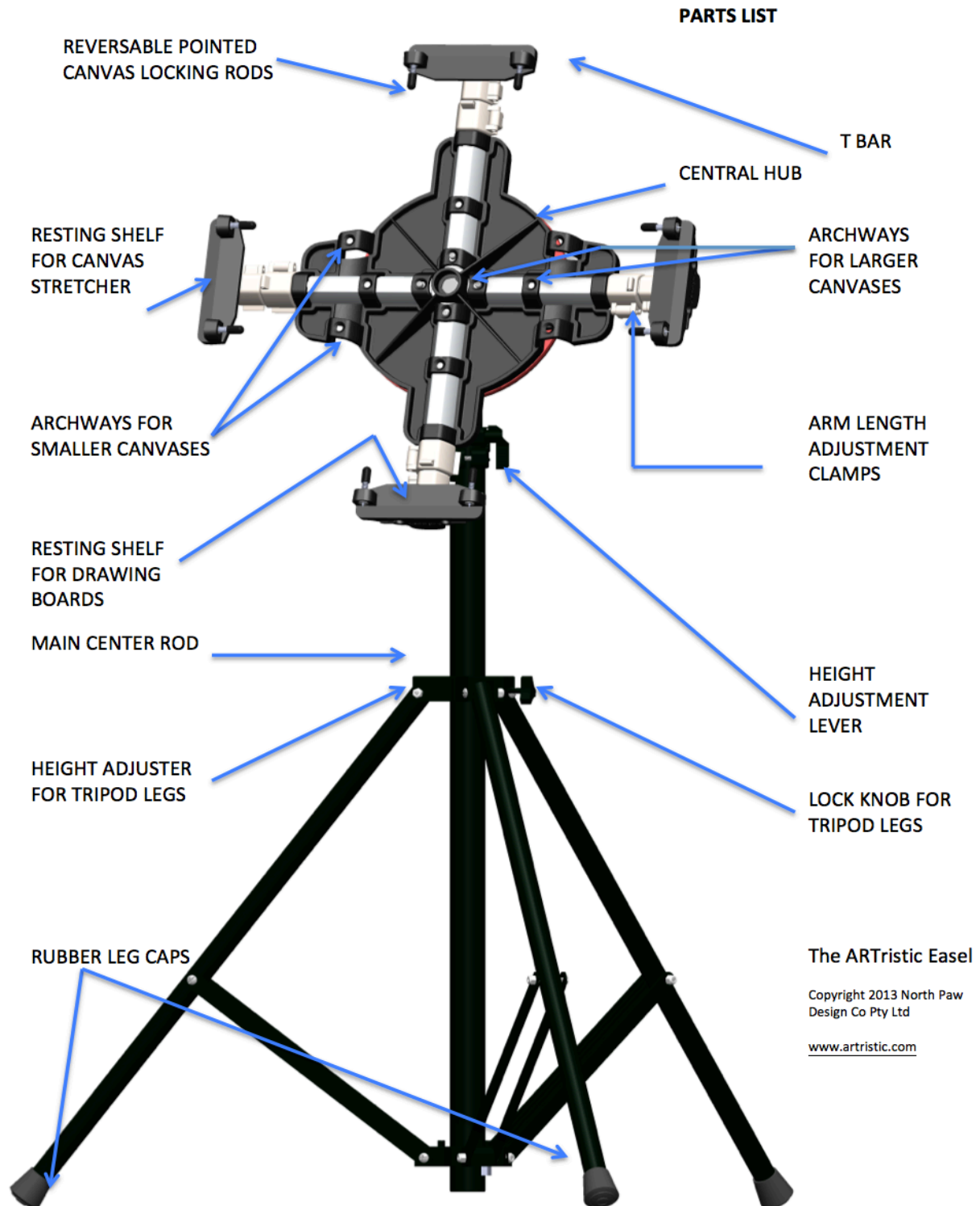

## HOW TO OPEN THE TRIPOD LEGS.

**IMPORTANT.** First make sure the knob here is not locked. Fully loosen it by turning to the left.

Hold two of the tripod legs half way down their length as in the photos below and give a quick sudden pull outwards with each hand to start the legs opening.



Then hold the tripod at the top section and place your other hand down flat onto the bottom section and push down smoothly to extend the legs fully.

Tighten the knob again when they are fully extended. No not over tighten.



## ADJUSTING THE HEIGHT OF CENTRE ROD OF THE TRIPOD.

To adjust the centre pole to the heights that you require for your canvas size and painting comfort, with one hand hold the pole to support the weight of the canvas or the steel disc and then pull this lever up to unlock it. Lower or raise the pole and instantly lock in place by pushing the lever down again. You can adjust the height continually as you paint



## ADJUSTING THE BLACK STEEL DISC

**\*NEVER TRY TO PUSH THE STEEL DISC DOWN FROM UPRIGHT TO HORIZONTAL WITHOUT FIRST LOSENING THE SIDE KNOB AND ALWAYS RE TIGHTEN BEFORE YOU PAINT.**

\*The disc is attached to the centre tripod pole by two side panels through which are 2 bolts. The top bolt is in a fixed and permanent position.

The bottom bolt has a black plastic knob or silver wing nut on one side. To alter the angle of the steel disc, hold the round knob on the opposite side and with the other hand loosen the black plastic knob or wing nut on the other side until it releases the pressure enough to allow you to freely move the disc.

Retighten the knob or wing nut when the disc is in its new position.

NOTE \*If you want the disc to be totally upright you can just place a book under the back tripod leg.

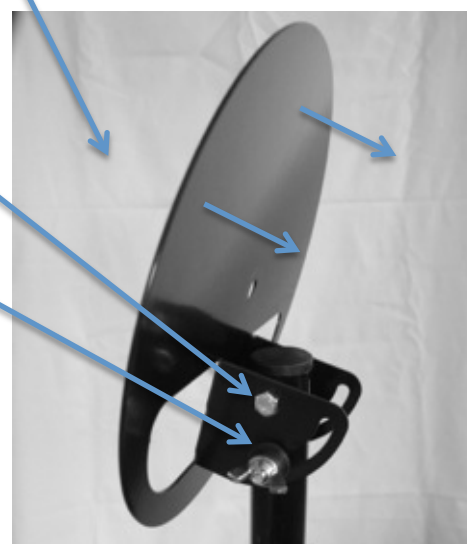



## HOW TO ATTACH THE CENTRAL HUB TO THE STEEL DISC

Remove large wing nut, silver washer, black plastic sleeve and the bottom silver washer from the foam side of the Hub. Lay Hub foam pad down, onto black steel disc and insert the long bolt into the center hole of the steel disc.

At the back of the black steel disc, slide one silver washer over the stem of the bolt. Then slide onto the bolt the small black plastic tube all the way down to the washer.

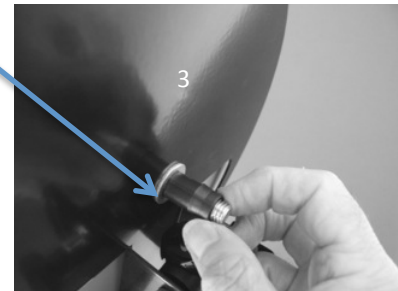
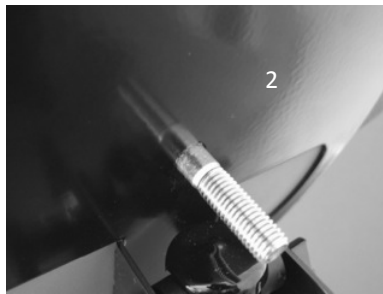

Place the other large washer onto the end of the bolt, and then add and tighten the large wing nut to bring Hub and steel disc firmly together. Adjust tension of the wing nut so that whatever position you have your canvas, it will stay in place. Always rotate canvas clockwise. Occasionally check that wing nut is tight and that steel disc and central hub are locked firmly together. Do not paint with them when they are loose.

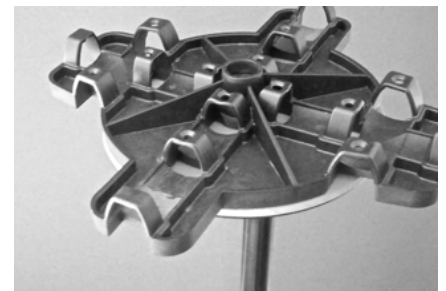

## HOW TO ATTACH THE ARMS TO THE CENTRAL HUB.

Tilt one arm down and insert into the first archway. Slide along to the middle archway and with tool supplied (Australia only) push the clear plastic cap down onto the button and slide the arm under the middle archway. USA customers use the end of a pen or pencil to push the buttons down.

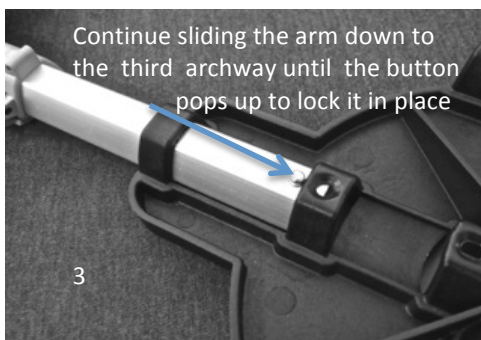
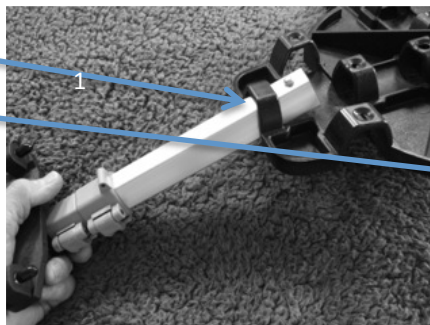

### NOTE\*

To attach a larger size canvas slide each arm along the centre archway until the button pops up to lock it in position here

PAGE 9 SHOWS THE OTHER POSITIONS YOU CAN LOCK THE ARMS INTO THE CENTRE HUB TO ACCEPT MANY DIFFERENT SIZE CANVAS STRETCHERS

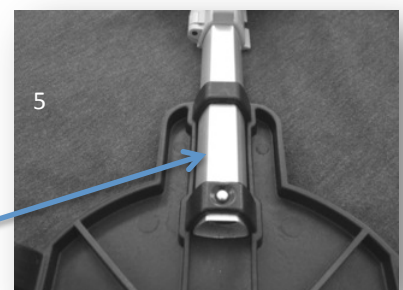

NOTE: See pages 9 and 10 for all the positions you can put the arms in

### HOW TO ATTACH A CANVAS FRAME

At the back of the canvas frame, make a mark in the centre of each of the four sides of the canvas frame.

**\*\*IMPORTANT\*\*IMPORTANT**

Remove the clear plastic safety caps from each of the eight pointed rods and adjust all the points so that only 5mm (1/4 inch) of each point is projecting

Rotate the Hub and position it as in the picture below and stand behind the easel.

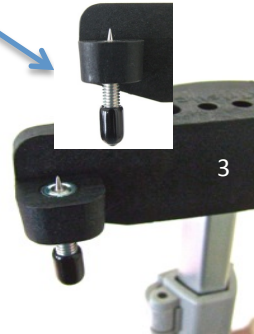
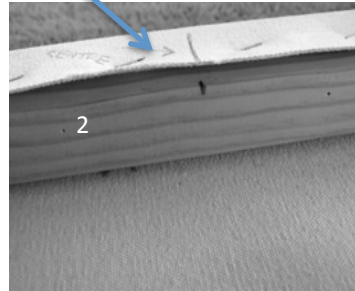
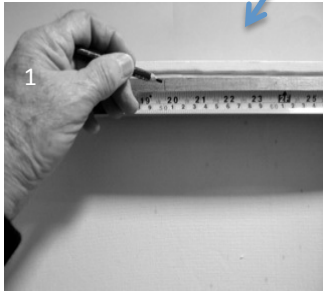

Unlock the one of the two adjustment clamps on the centre arm and raise the arm upwards and relock.

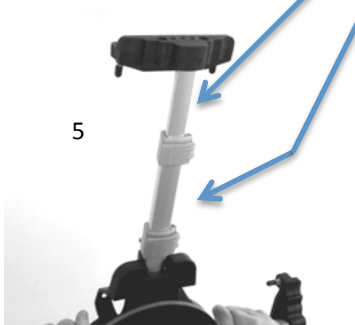

6 Place a canvas **in front of the easel** and then stand **BEHIND** the tripod legs with one of its legs to the left of you and other to the right of you with the third leg positioned between your legs.

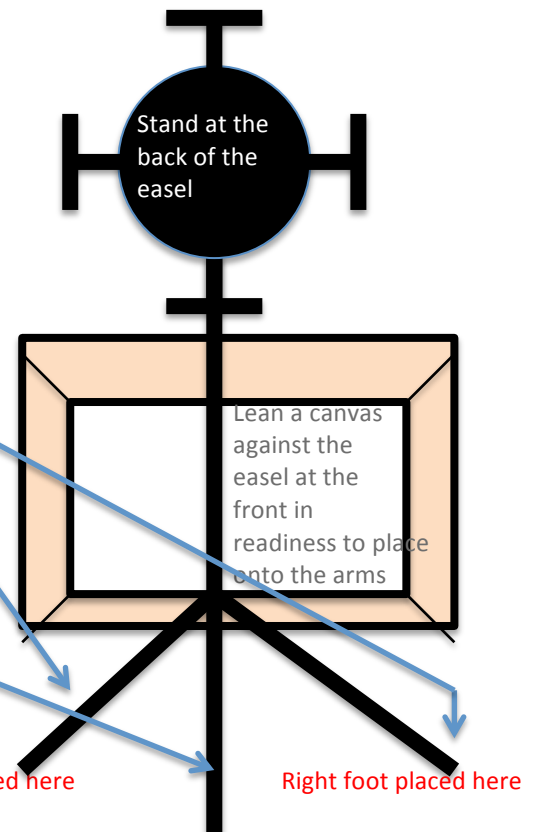

With your arms either side of the easel, reach forward and lift the canvas up.

Lower the centre of the canvas frame down onto the resting shelf of the T bar and squeeze the frame down onto the two projecting points.

Always make sure that the canvas frame sits flush up against the back of the T Bar shelf

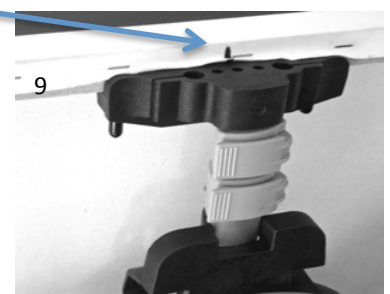
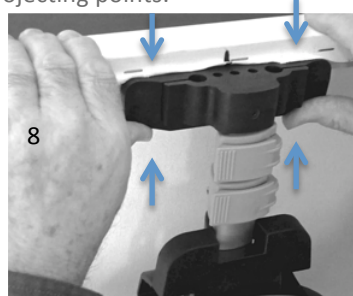

### HOW TO ATTACH A CANVAS FRAME (continued)

Now unlock the adjustment clamps of the centre arm and ensuring the canvas frame stays sitting on the T bar, carefully lower or raise the centre arm (and the canvas with it) until the marks you have made on the sides of the canvas frame line up with the left and right arm. Then relock the upright top arm. It's important that the canvas is locked to the T bars in the centre of each of the four side of the wooden frame

Now unlock the left arm clamp and extend it until the T bar shelf connects with the left of the canvas frame side in the same way that the centre one did. Then lock the arm clamp the same as you did the centre one.

Now extend the right arm and lock to the T bar to the canvas frame as you did the top centre one, followed by the bottom arm.

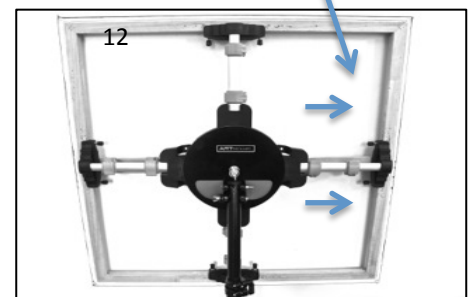
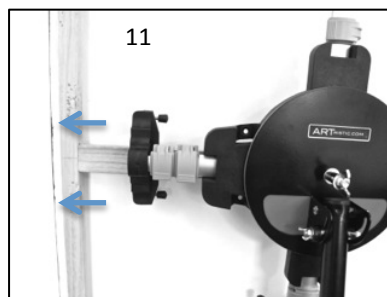
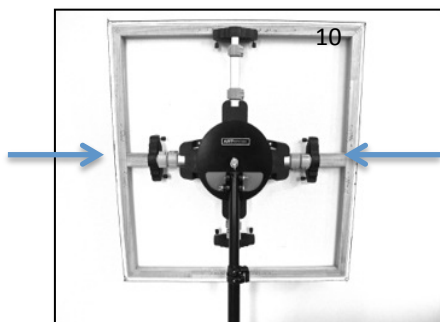

### ATTACHING A CANVAS :

#### A VERY IMPORTANT STEP.

Now rotate the canvas frame SLOWLY and double check that points of each of the 8 rods are digging 5mm into the wood. You can if you wish give each pointed rod two or three turns to ensure they are. Please don't over screw. Those 8 points are more than enough to hold the canvas frame very securely. If you have connected it correctly the canvas will not fall off the easel.

\*It's worth taking a bit of extra time here to make sure the canvas frame is securely locked onto the T bar shelves.

### HOW TO TILT A CANVAS

Whenever you tilt the canvas to lean back, to lay flat/ horizontally or to return it to an upright position **YOU MUST ALWAYS LOOSEN THIS KNOB OR WING NUT**. Failure to do so could damage or bend the black steel disc especially if you try to force the canvas to tilt.

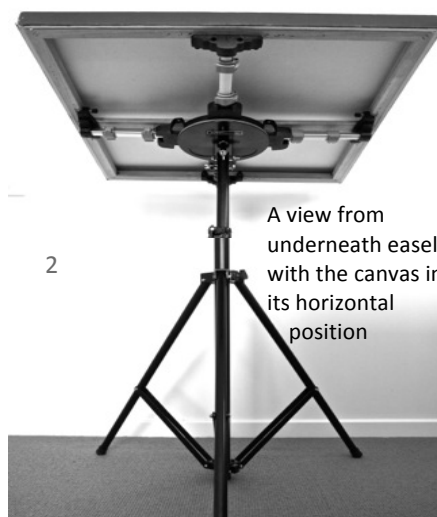
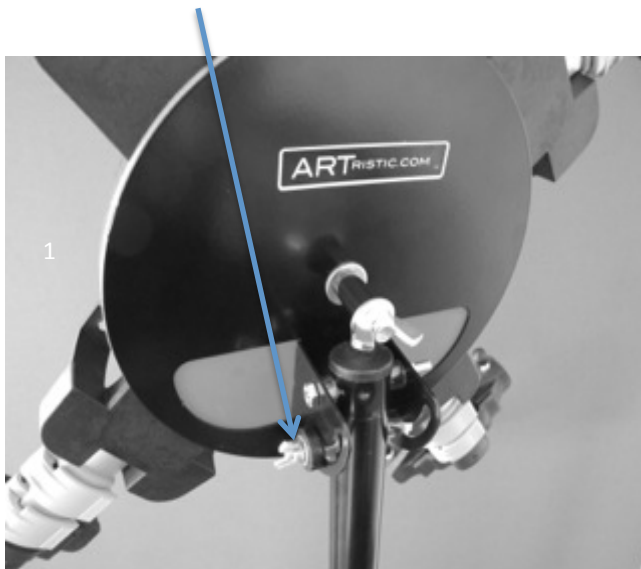

A view from underneath easel with the canvas in its horizontal position



A view from top with canvas in its horizontal position



## HOW TO QUICKLY REMOVE A CANVAS FROM THE EASEL

Stand behind the back of the canvas and flip up one of the left arm adjusting clamp or clamps.

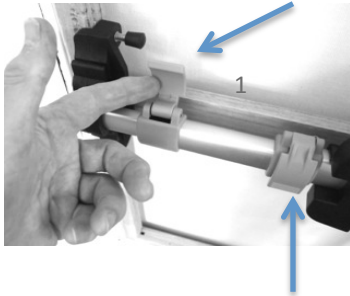

Hit/tap the end of the T bar hard towards the centre of the canvas to release it from the canvas frame

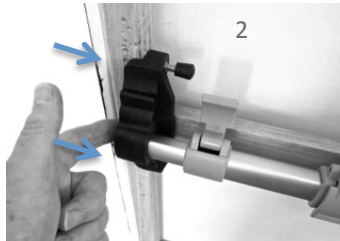

Then repeat with the right arm and the bottom arm.

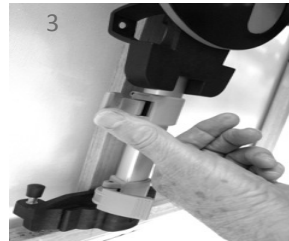

Now just lift the canvas off from the top T bar.



## HOW TO ATTACH THIN BOARDS OR THIN CANVAS COVERED BOARDS.

**\*Using piece of foam supplied with the easel. \*USA customers please substitute foam with paper card or cloth pad**

Loosen the side plastic knob on the side of the steel disc and push the Hub into its horizontal position. Adjust the Hub height to waist level.



Screw the 8 pointed rods all the way down to the black plastic end

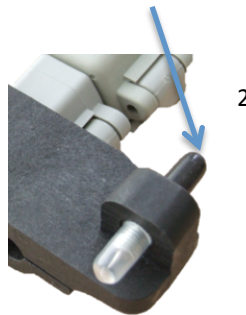

Unlock and fully extend all four arms and leave them all unlocked.

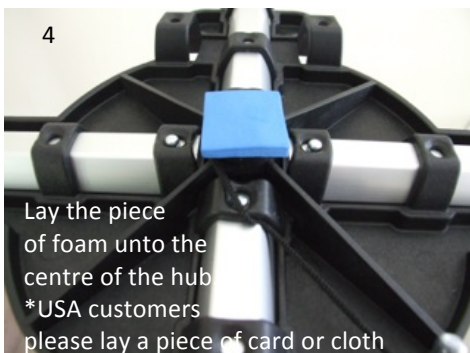
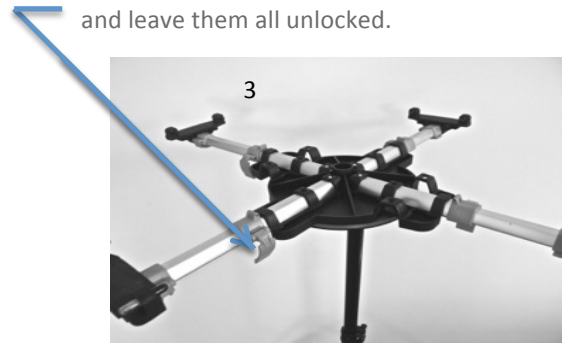

Lay a thin canvas board or a drawing board onto the centre of the Hub



Push each T bar towards the edge of the drawing board and slide the black caps over the top edge of the drawing board. Repeat for all four arms.

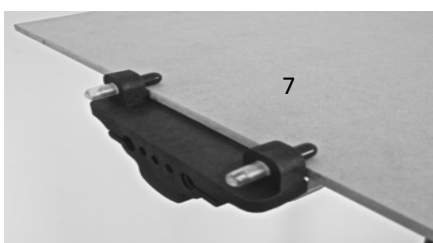
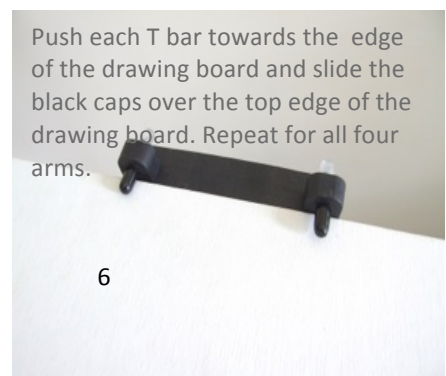

Underneath the board, lock all of the arm clamps to hold the board in position

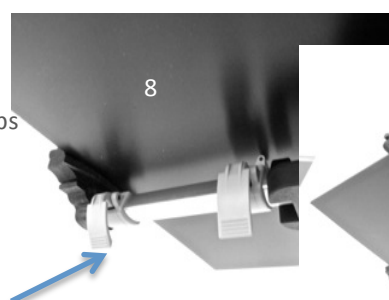

View from underneath the drawing board just before the arm clamps are locked

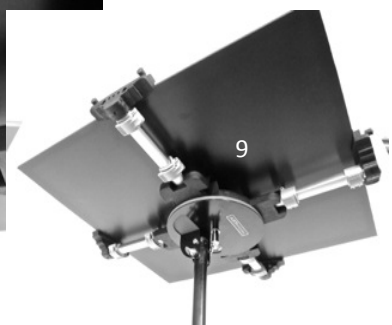



## HOW TO SET UP THE EASEL TO TAKE THICKER DRAWING BOARDS

(up to maximum of 10 mm (1/2 inch thick ) and no larger than 70cm in width or length (30inches)

\*Do not place very heavy, large boards onto the easel

Reverse the 8 pointed rods as shown below and prepare the easel as for a thin but don't put the foam into the centre of the Hub. Adjust the arms so that the points make contact with the four side edges of the board. Lock the arms in place from underneath then screw the points of the rods into each of the four outside edges sides of the drawing board as shown below.

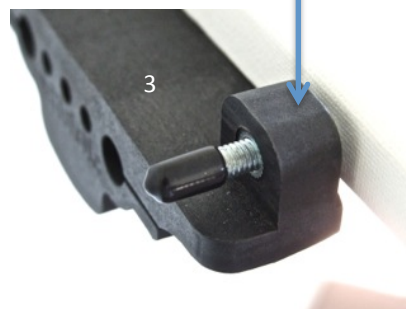
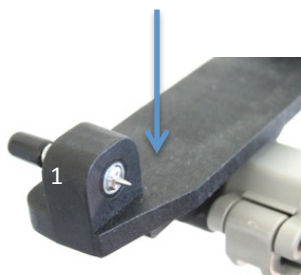

## HOW TO TURN AN OLD CANVAS STRETCHER FRAME INTO A DRAWING BOARD.

Cut a piece of drawing board material to fit the front of a canvas stretcher. Then just glue it on to the canvas. Builders silicone or almost any other type of glue will do it. Then attach the canvas frame to your easel the same way as a canvas frame.

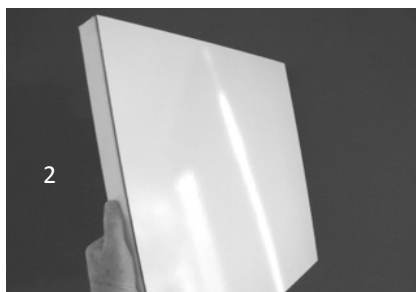
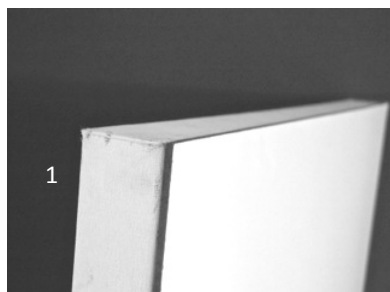

Scroll down to page 10 for more detailed instructions of how to make a drawing board

## HOW TO MAKE A CLEANING RAG HOLDER FOR YOUR EASEL

Insert a long plastic cable tie into the two large holes on the end of a T bar and then lock it in.

\*You can also use a 54cm length of 6mm round clear plastic tubing available from the gardening section of Bunning's or your local hardware shop

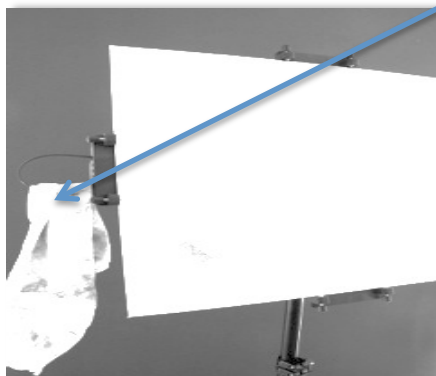
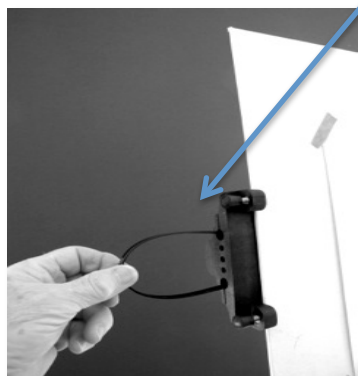

### THE MAIN POSITIONS YOU CAN LOCK THE ARMS INTO

NOTE: By using combinations of four, three or two arms and sometimes reversing the pointed rods, you can attach canvas frames from approx 5 inches x 5 inches up to approx 48 inches x 48 inches max depending on the width of the sides of the frame.

#### FIRST MAIN POSITION (medium size canvas)

Lock all four arms down to the first position archway. This will take canvas stretchers from approximately.....

20 inches up to 43 inches  
(51 cm) (109cm)

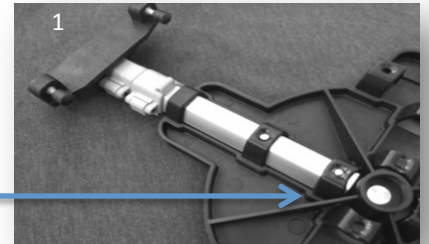

#### SECOND MAIN POSITION (largest size canvas)

Lock all four arms into the second position archway. This will take canvas stretchers from approximately.....

25 inches up to 48 inches  
(63 cm) (122cm)



#### THIRD MAIN POSITION (smaller size canvas)

\*Remove all arms and insert only three as indicated.

Will take canvas stretchers from approximately.....

17 inches up to 20 inches  
(43cm up to (51cm)



#### OTHER POSITIONS

(for very small size canvas or boards)

Remove all arms and re insert only three or two arms as shown. You can also reverse the pointed locking rods if you wish. \*Please do experiment and let us know if you discover any more positions.

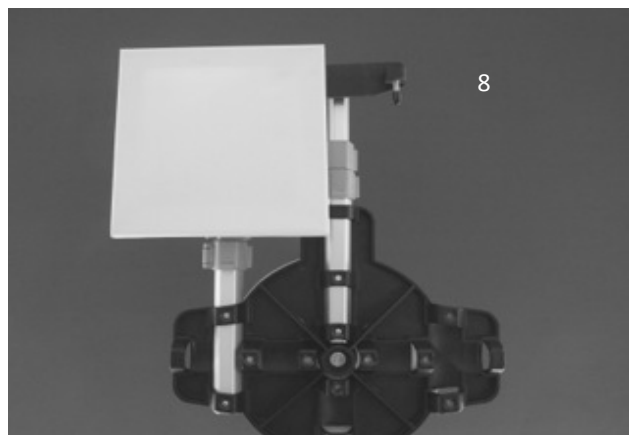
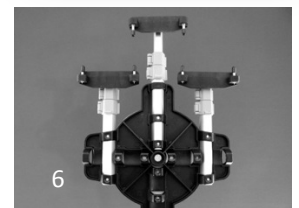

## HOW TO MAKE YOUR OWN "QUICK ATTACH" DRAWING BOARD TO FIT ONTO THE ARTistic EASEL

For artists that do a lot of water colour or pastel painting, this drawing board will be faster and easier to attach to the easel and save you time. Australian artists can purchase 3mm thick Melamine white covered board here.

[http://www.bunnings.com.au/customwood-mdf-1200-x-600-x-3mm-white-melamine\\_p0610151](http://www.bunnings.com.au/customwood-mdf-1200-x-600-x-3mm-white-melamine_p0610151)

NOTE: Silicone or almost any other type of glue will stick the back of Melamine board to a canvas.

USA artists can purchase ¼ inch thick Melamine board at these or companies or other hardware stores

<http://www.menards.com/main/home.html>

<https://www.plywoodcompany.com/application/home/products/prefinishedpanels.aspx>

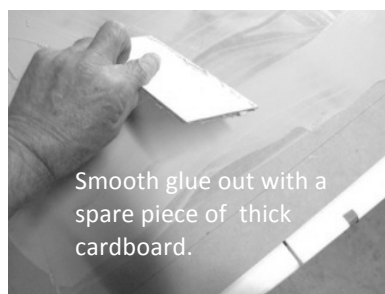
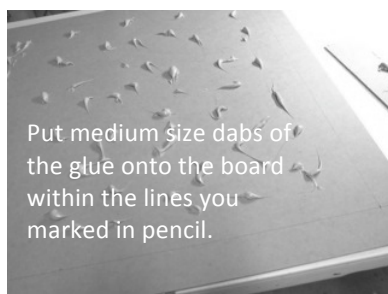
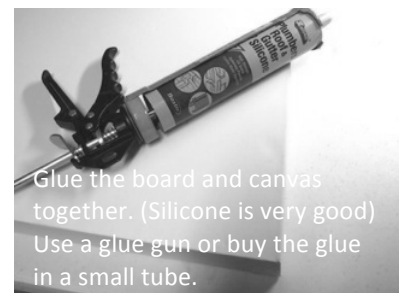
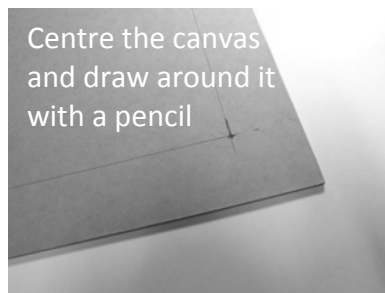
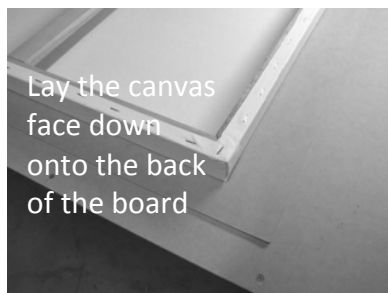
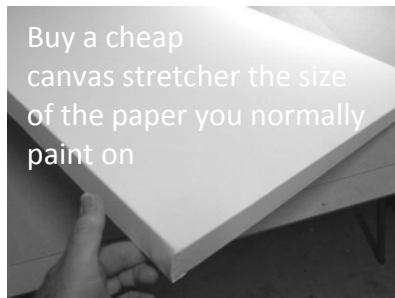

\*Use tape or use bull dog clips to attach your art paper to the face of the board.

### PLEASE CONTACT ME AT

email [northpaw@bigpond.com](mailto:northpaw@bigpond.com)

IF YOU HAVE ANY EXTRA QUESTIONS OR NEED ANY ADVICE OR HELP WITH THESE INSTRUCTION

### MORE POSITIONS YOU CAN LOCK THE ARMS INTO



FOR VERY  
SMALL  
CANVAS



If you have any questions please do not hesitate to email Tony at [northpaw@bigpond.com](mailto:northpaw@bigpond.com)  
If you include your phone number he is more than happy to call you in Australia, USA or Canada